

4

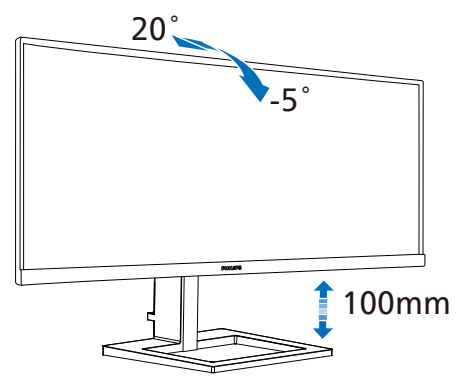

5

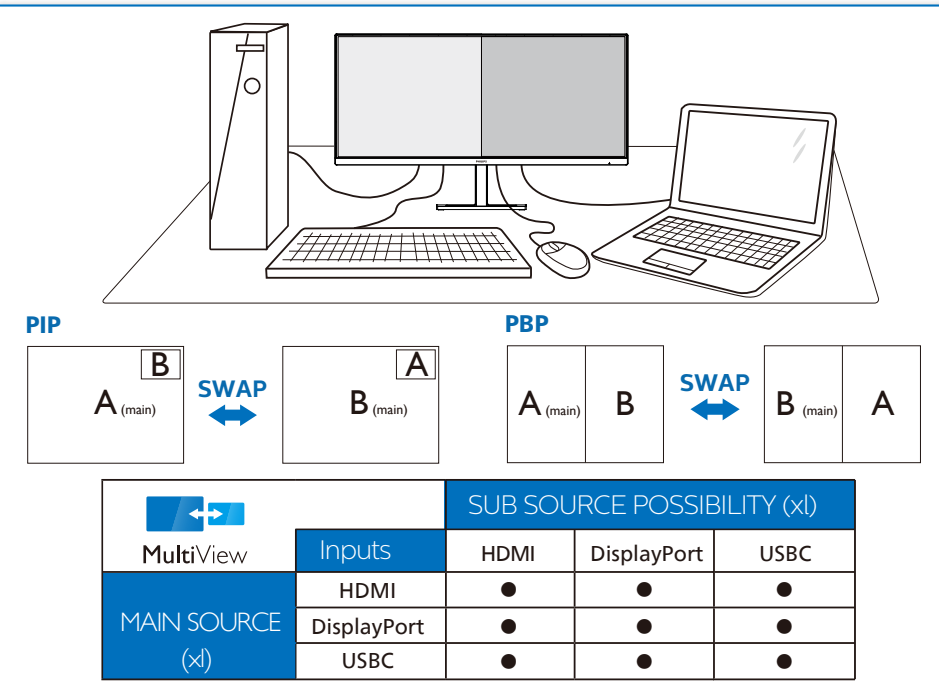

Register your product and get support at
www.philips.com/support



Version: M2346ELEQ1T
 2022 © TOP Victory Investments Ltd. All rights reserved.

This product has been manufactured by and is sold under the responsibility of Top Victory Investments Ltd., and Top Victory Investments Ltd. is the warrantor in relation to this product. Philips and the Philips Shield Emblem are registered trademarks of Koninklijke Philips N.V. and are used under license.

Specifications are subject to change without notice.

HDMI

The Adopted Trademarks HDMI, HDMI High Definition Multimedia Interface, and the HDMI Logo are trademarks or registered trademarks of HDMI Licensing Administrator, Inc. in the United States and other countries.

www.philips.com

Energy Labelling

346E2LAE



Printed in China



H41G78S381360A

PHILIPS

E Line

346E2



Quick Start

Register your product and get support at
www.philips.com/welcome

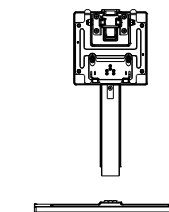
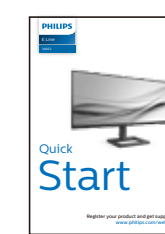
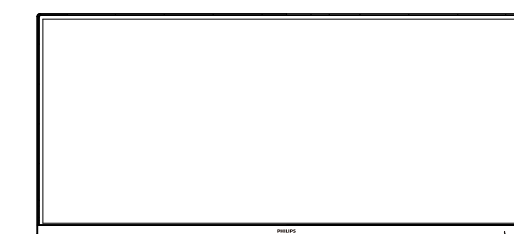

Stand/Base

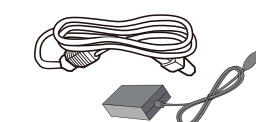

AC/DC Adapter

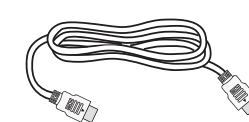

* HDMI

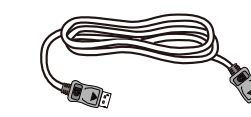

* DP

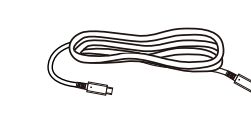

*USB C-C

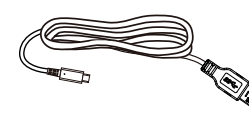

*USB C-A

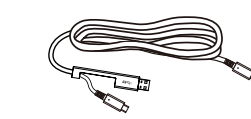

*USB C-C/A

* Different according to region.
 Display design may differ from those illustrated.

1

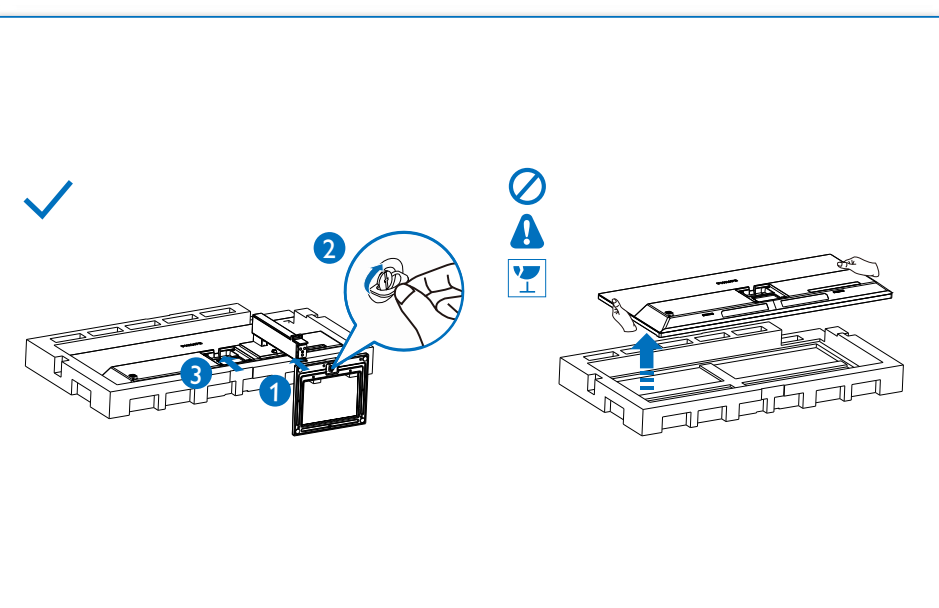

2

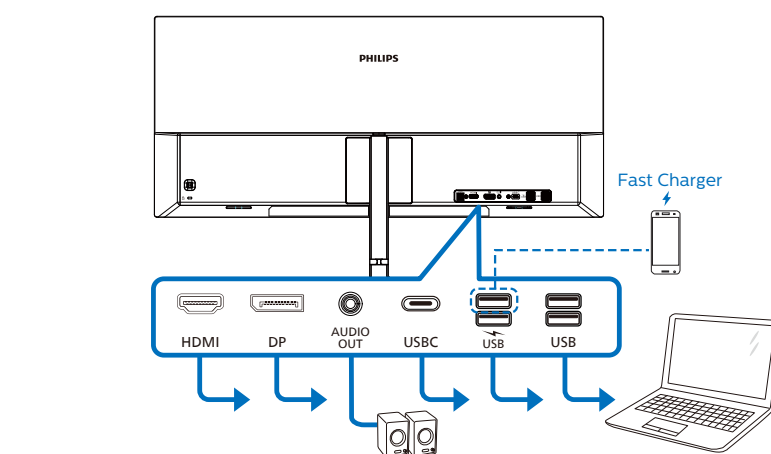
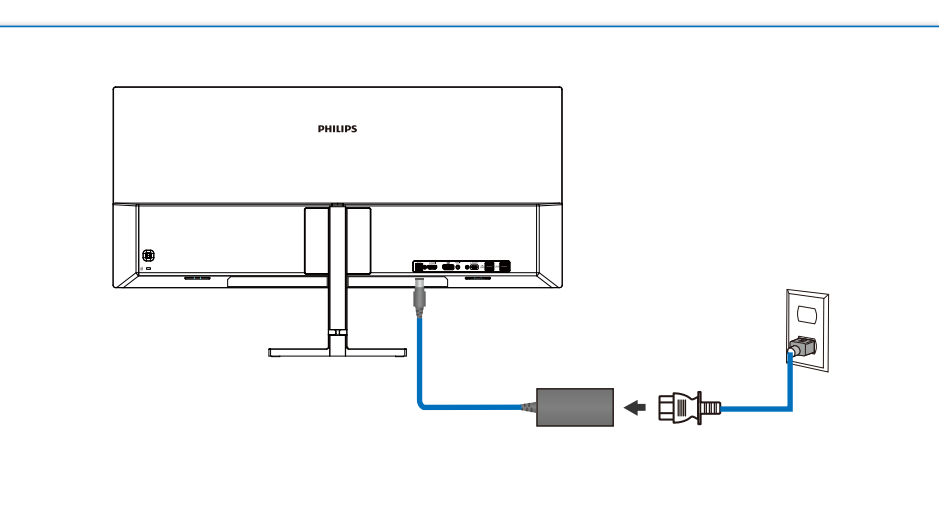

USB C-C

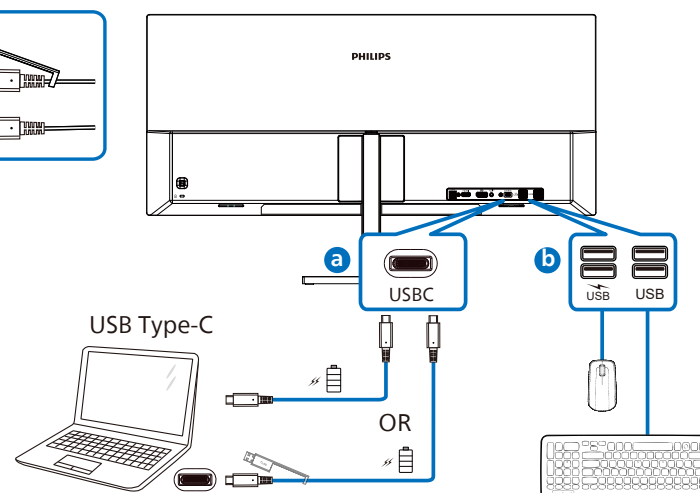
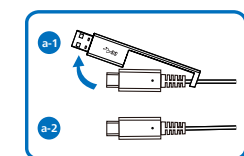

USB Type-C



USB A-C

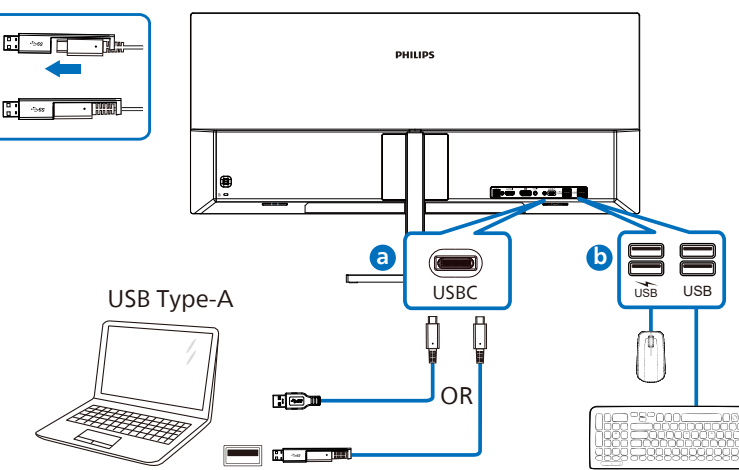
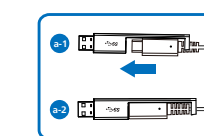

USB Type-A

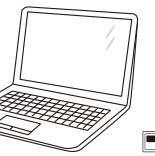

3

