

3

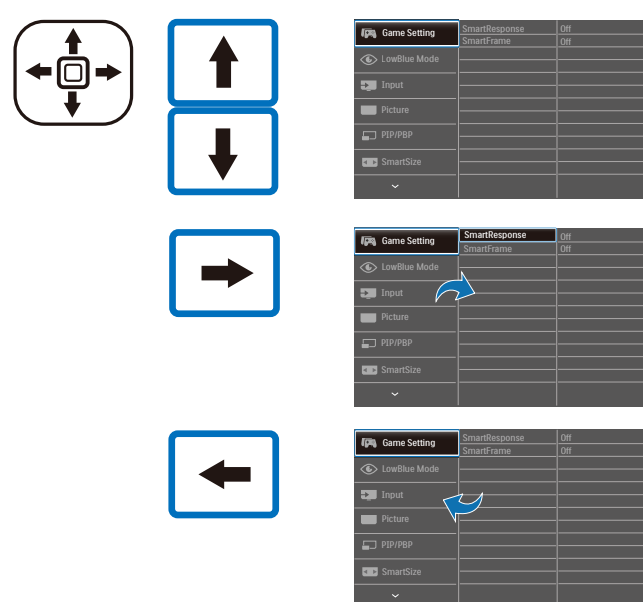

4

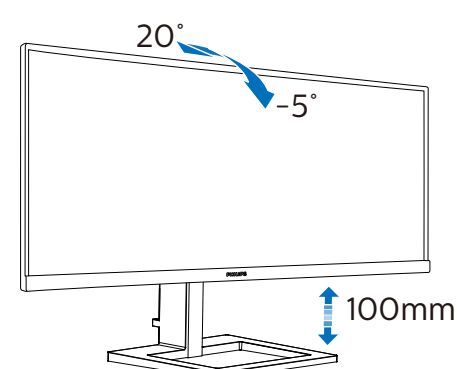

Register your product and get support at  
[www.philips.com/support](http://www.philips.com/support)



FAQ

Software  
SmartControlUser  
Manual

Version: M2345EEQ1T  
 2020 © TOP Victory Investments Ltd. All rights reserved.

This product has been manufactured by and is sold under the  
 responsibility of Top Victory Investments Ltd., and Top Victory  
 Investments Ltd. is the warrantor in relation to this product.  
 Philips and the Philips Shield Emblem are registered trademarks  
 of Koninklijke Philips N.V. and are used under license.

Specifications are subject to change without notice.

**HDMI**

The terms HDMI, HDMI High-Definition Multimedia  
 Interface, and the HDMI Logo are trademarks or  
 registered trademarks of HDMI Licensing  
 Administrator, Inc.

[www.philips.com](http://www.philips.com)

Energy Labelling

345E2AE



Printed in China



H41G78S281366C

**PHILIPS**

E Line

345E2



# Quick Start

Register your product and get support at  
[www.philips.com/welcome](http://www.philips.com/welcome)

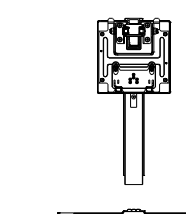
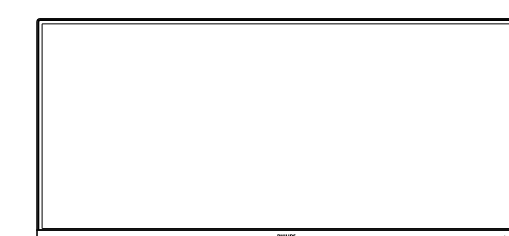

Stand/Base

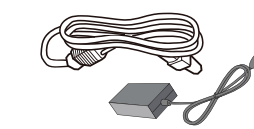

AC/DC Adapter

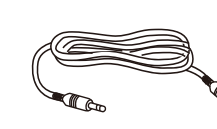

\* Audio Cable

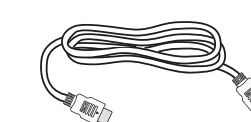

\* HDMI

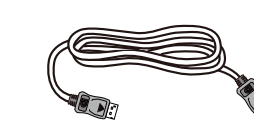

\* DP

\* Different according to region.  
 Display design may differ from those illustrated.

1

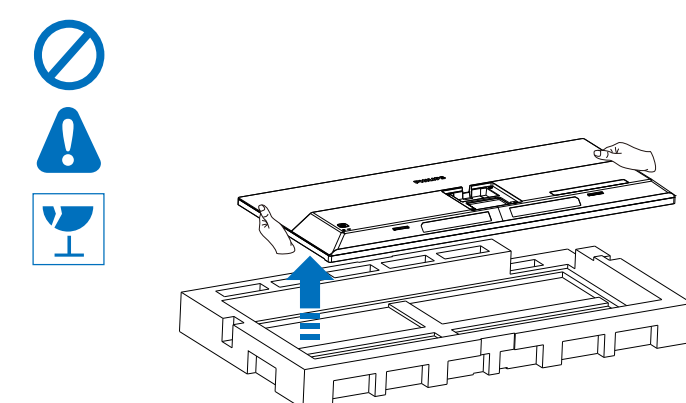
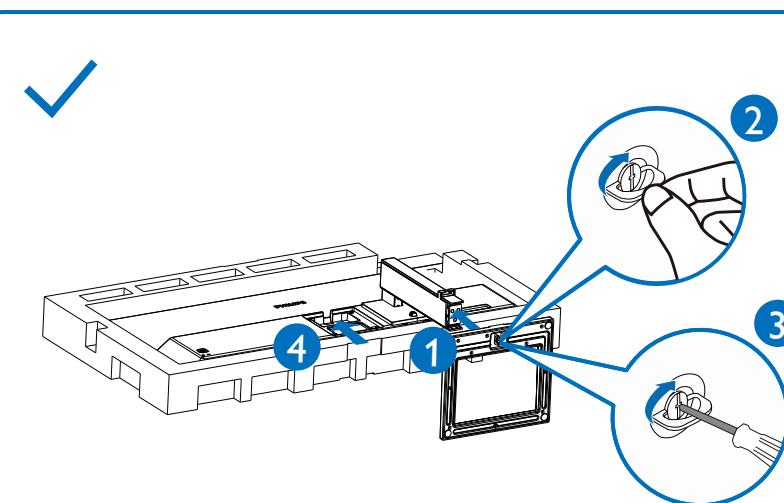

2

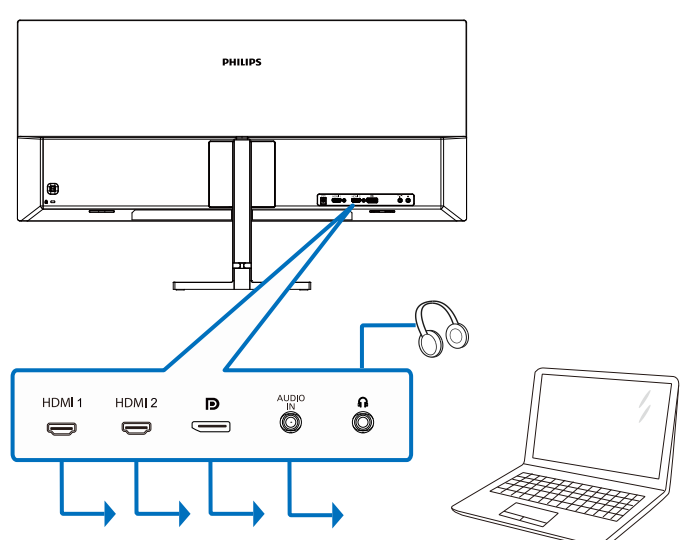
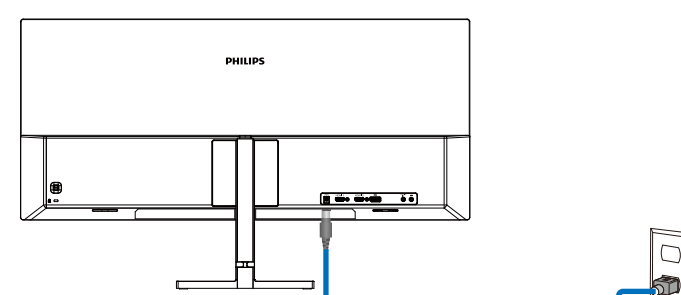

3

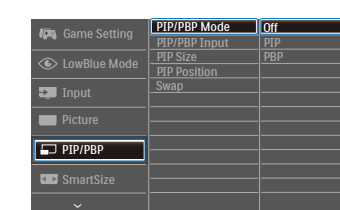
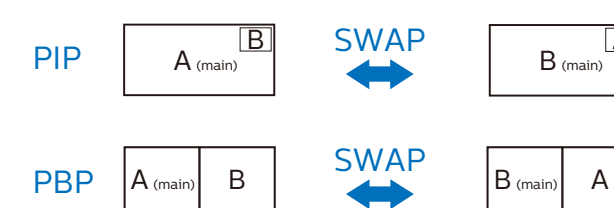
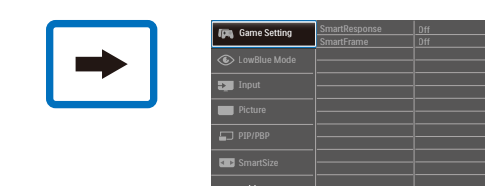
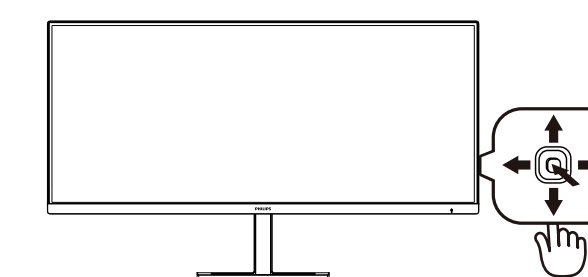

		SUB SOURCE POSSIBILITY (x1)		
MultiView	Inputs	HDMI 1	HDMI 2	DisplayPort
	HDMI 1	•		•
	HDMI 2		•	•
	DisplayPort	•	•	•