

4

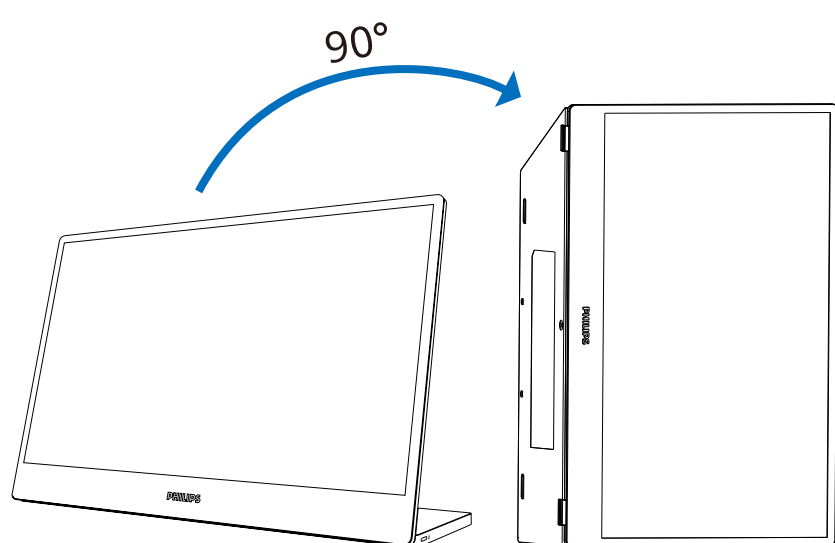

Register your product and get support at [www.philips.com/support](http://www.philips.com/support)

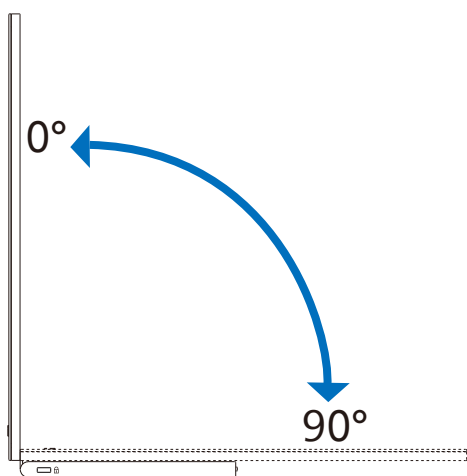
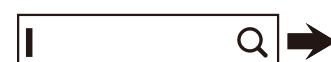

FAQ



Software  
SmartControl



User  
Manual

Energy Labelling  
16B1P3302



Printed in China



F41G16M1813-2B----

Version: M1116BU3302Q1WWL  
2022 © TOP Victory Investments Ltd. All rights reserved.

This product has been manufactured by and is sold under the responsibility of Top Victory Investments Ltd., and Top Victory Investments Ltd. is the warrantor in relation to this product. Philips and the Philips Shield Emblem are registered trademarks of Koninklijke Philips N.V. and are used under license.

Specifications are subject to change without notice.

[www.philips.com](http://www.philips.com)

PHILIPS

Portable  
Monitor

3000 Series



16B1P3302

# Quick start

Register your product and get support at [www.philips.com/welcome](http://www.philips.com/welcome)



Contents

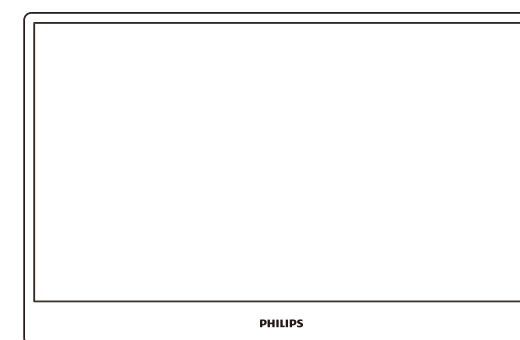

\*USB C-C/A

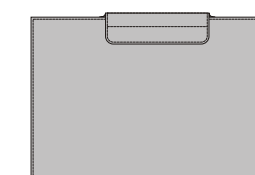

\*Protective case

\*Different according to region  
Display design may differ from that illustrated

1

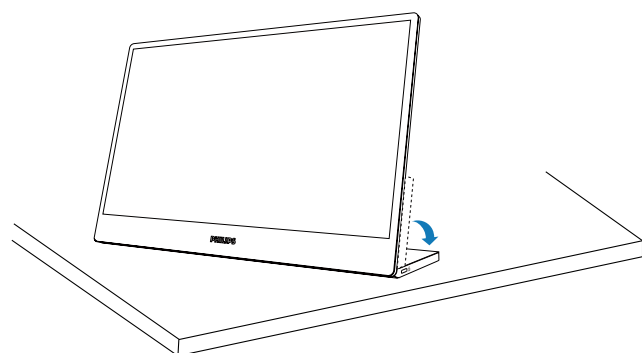

▲ CAUTION: Place the monitor face down on a smooth surface. Pay attention not to scratch or damage the screen.

2

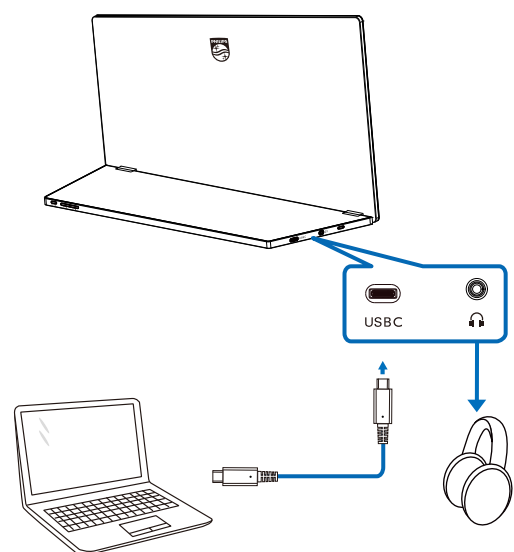

USB C-C

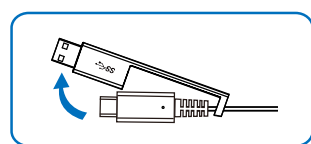

USB Type-C

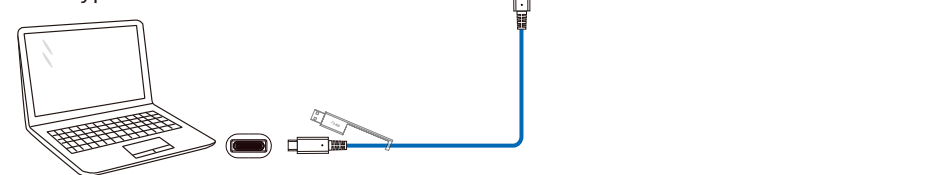

USB A-C (DisplayLink)

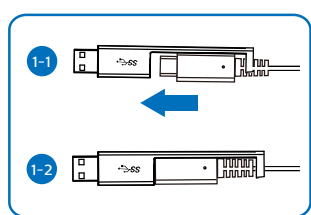

USB Type-A + DisplayLink driver

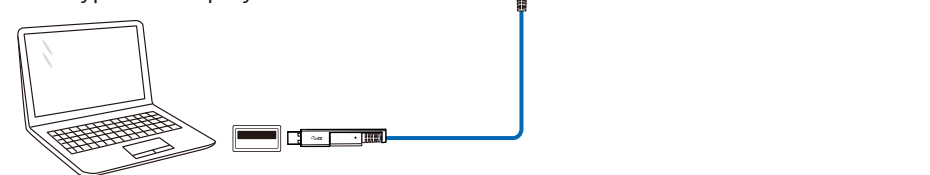

3

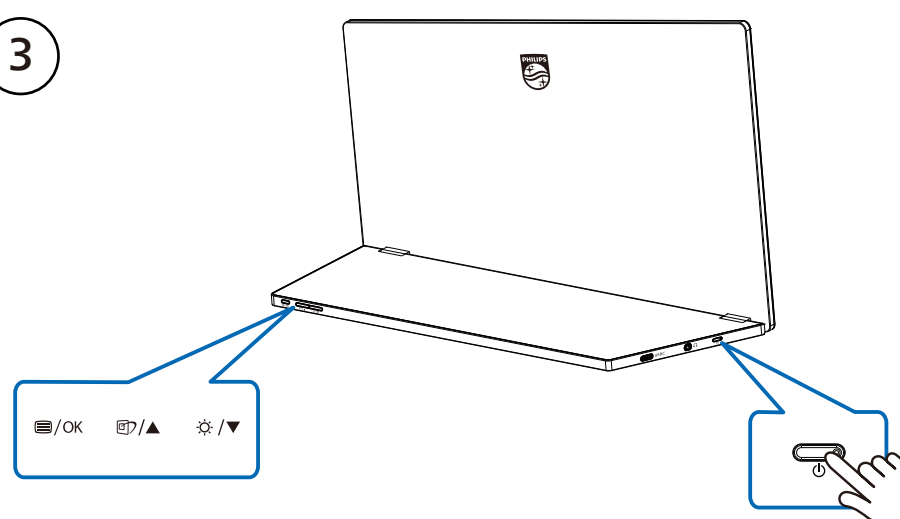

Brightness - + 90



SmartImage  
EasyRead  
Office  
Photo  
Movie  
Game  
Economy  
LowBlue Mode  
Off



LowBlue Mode	On	Off	✓
Picture			
Audio			
Color			
Language			
OSD Setting			



LowBlue Mode	On	Off	✓
Picture			
Audio			
Color			
Language			
OSD Setting			



LowBlue Mode	On	Off	✓
Picture			
Audio			
Color			
Language			
OSD Setting			